

別添1

米子市

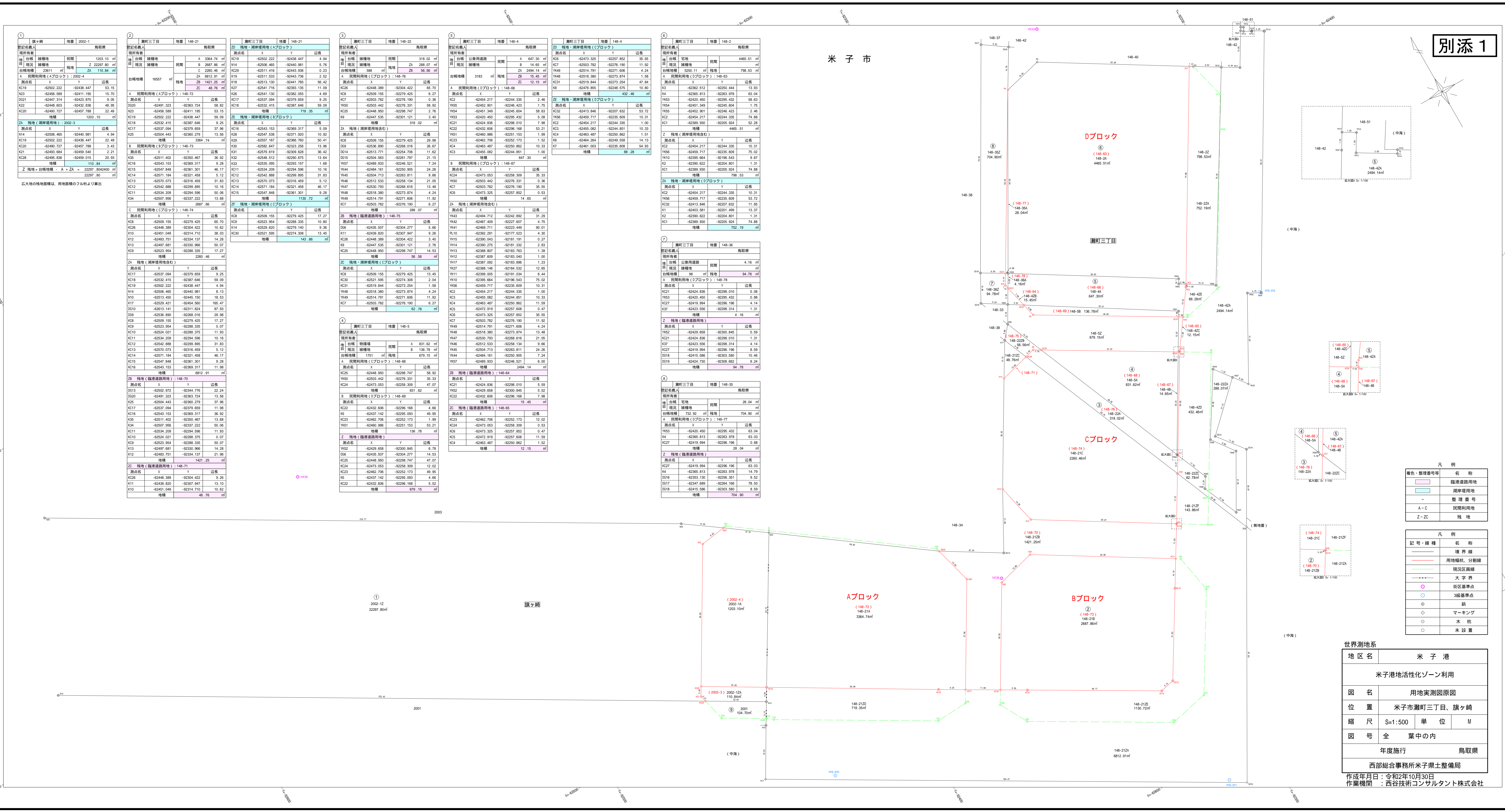

Table 1: Land parcel details for Block A (Aブロック). Includes columns for parcel ID, area, and owner information.

Table 2: Land parcel details for Block B (Bブロック). Includes columns for parcel ID, area, and owner information.

Table 3: Land parcel details for Block C (Cブロック). Includes columns for parcel ID, area, and owner information.

Table 4: Land parcel details for Block D (Dブロック). Includes columns for parcel ID, area, and owner information.

Table 5: Land parcel details for Block E (Eブロック). Includes columns for parcel ID, area, and owner information.

Table 6: Land parcel details for Block F (Fブロック). Includes columns for parcel ID, area, and owner information.

Table 7: Land parcel details for Block G (Gブロック). Includes columns for parcel ID, area, and owner information.

Table 8: Land parcel details for Block H (Hブロック). Includes columns for parcel ID, area, and owner information.

Legend (凡例) section containing two tables: one for symbols and colors used in the map, and another for symbols and colors used in the site plan.

Metadata table for the site plan, including location (米子市), scale (1:500), and date of issue (2023.10.30).

湖岸用地は、将来、国土交通省中国地方整備局出雲河川事務所が湖岸堤の整備を予定している土地である。( )内の赤字は、登記完了証(登記年月日:令和2年9月7日)を基に記載。